



Example Logo

Check Out Report

Residence: Address: 51f Sample Street

No Mans Land

London

Postal Code: N19 5JT

Produced By: Clerk: John Doe

Company: An Inventory Clerk Company

Telephone: 0845 869 3032

On Behalf Of: Contact: Joe Bloggs

Company: An Estate Agent

Date: 25 July 2008

Contents

General Notes and Guidance	3
Schedule of Conditions	4
Overview	5
Signature Page	6
Floorplan	7
Dilapidation Ammendments	8

General Notes and Guidance

The inventory was intended as an independent and informative guide to both landlord and tenant about the condition of any fixtures, fittings, furniture, contents and decor.

The inventory description enabled items to be visually identified only, no attempt was made to identify any item by its original manufacturer or the period in which it was produced. The inventory clerk who prepared the inventory report and / or carried out the check-in is not an expert on fabrics, woods, materials, antiques, etc., nor do they purport to be a qualified surveyor. The inventory should not be used as a structural survey report.

Unless otherwise stated, it was accepted that a listed item was in good condition free from any obvious defects, soiling or malfunction, which may constitute a dilapidation assessment on termination of tenancy.

Clerks did not undertake to move heavy and/or awkward items of furniture.

Inaccessible areas and loft spaces were not searched or listed in the inventory.

All regulations published by the Department of Trade and Industry / Trading Standard Services and / or similar bodies are the ultimate responsibility of the Instructing Principal. Where the inventory noted FFR label, this was not interpreted to mean that the item complied with the Furniture & Furnishings (Fire) (Safety) (Amendments) 1993. It was a record that the item had a label as described or similar to that detailed in the Guide published by said bodies at the time of the inventory make. It was not a statement that the item was considered to comply with the regulations.

All electrical items were considered complete with plugs, bulbs, flexes etc. unless otherwise specified. When practicable to do so, all appliances were tested for power only. The inventory relates only to furniture, furnishings and all of the Landlords' equipment and contents in the property. It was no guarantee of, or report on, the adequacy of, or safety of any such equipment or contents, merely a documented record that such items existed within the property, at the date of the inventory and the superficial condition of the same.

All plants were considered as perishable items and were not listed.

All measurements given were approximate.

On termination of the tenancy the check-in inventory was rechecked, any discrepancies and / or variations are listed. This report indicates, in the opinion of the Clerk, whether there is any liability on the tenant, or whether such deterioration could be assessed as fair wear and tear. Fair wear and tear is assessed on the length of the tenancy and the type of occupancy, noting that certain items received higher usage. The Clerk acknowledges that the contractual terms listed in the tenancy agreement may overrule the opinion of the assessor.

Full Terms and Conditions available upon request.

Schedule of Conditions

Residence:	51f Sample Street	Furnished
		Condition: N/A
	No Mans Land	Garden: N/A
	London	
	N19 5JT	

Meters Readings:				
	Location	Reading	Reference	Supplier

Keys:	collect keys: at property						
	return keys: to agent						
Key Set	Cylinder	Mortice	Ingersoll	Remote	Alarm Fob	Banham	Reference
Front Door	2	2	-	-	-	-	

Overview

Property Overall: N/A

Garden: N/A

Cleanliness

The following is an indication of the level of cleanliness attributed to the overall property in the view of the inventory clerk, for individual room and / or item conditions, please refer to the following pages.

Item	Level of Cleanliness
Doors	need cleaning
Skirting	need cleaning
Woodwork	need light clean
Paintwork	need cleaning
Windows	need cleaning
Flooring	need cleaning
Carpets	need vacuum / dusting
Tiles	professional
Linen	n/a
Curtains /Blinds	good domestic
Mattresses	good
Hob	need light clean
Oven	need light clean
Kitchen	need cleaning
Bathroom	need cleaning
Fireplaces	n/a

Additional Comments:

The Clerk is aware that there are varying acceptable standards among landlords, where it is written 'landlords discretion' it is to mean that if the landlord chooses to make good an item or replace it, if need be, the Clerk will support the landlord in their decision.

Forwarding Address:

Please sign to say that you agree with the following statements :

- 1. I am satisfied that the meter readings are true and correct.
- 2. To the best of my knowledge the forwarding address is true and correct.
- 3. I have returned the keys named and quantified on the schedule of conditions.
- 4. I agree with the dilapidation amendments

Signed for the tenant _____ Print _____



Witnessed by: _____ Print John Doe

Floorplan

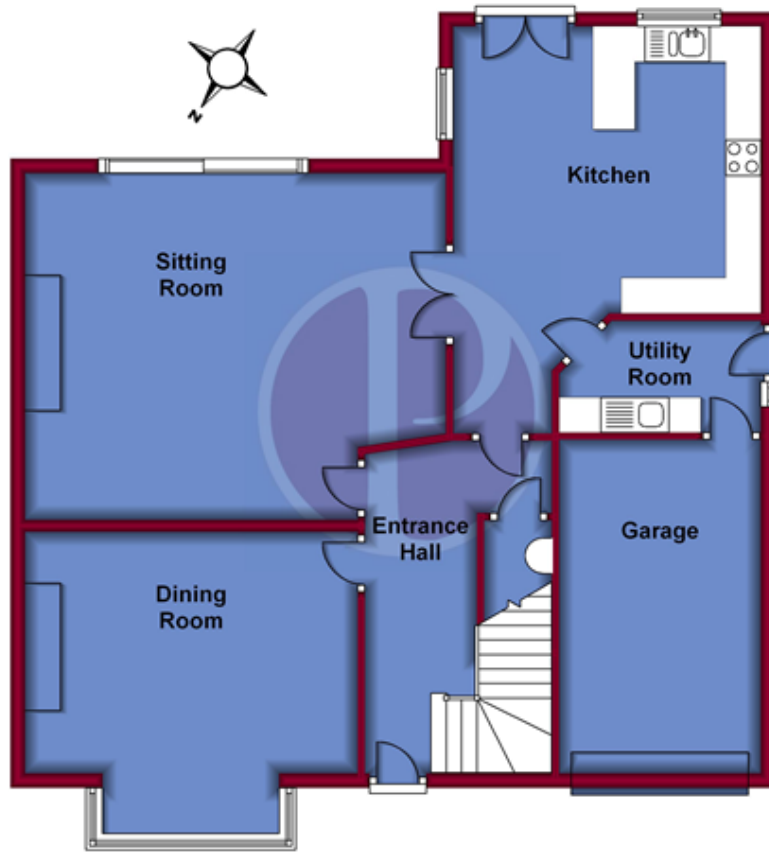

Total area: approx. 95.4 sq. metres (1026.7 sq. feet)

[Example floor plan here](#)

Room 1: Garden
Front

	Description	Check-Out Update	Comment
Flooring			
1	Drive way	tarmac	
2	Lawn	turf	
Walls			
3	Wall	brick	
Lighting			
4	Garden lighting	security sensed floodlight	
Furnishings			
5	Beds	planted	severely weeded/over grown tenant liability

Room 2: Entrance Hall

		Description	Check-Out Update	Comment
Doors				
6	Threshold (external)	concrete.		
7	Door (external)	panelled wood painted black, yale lock brass, chubb lock brass, knob handle brass, letterbox with cover brass weatherboard painted black		
8	Frame & architrave (external)	painted white, doorbell brass, 2 chips decorative Mezuzah black / brass		wear & tear
9	Threshold	silver		
10	Door	panelled wood painted white, yale deadlock brass, chubb lock with cover brass, letterbox with cover, 2 bolt(s) silver		
11	Frame & architrave	painted white, cable		
12	Threshold 2	wood		
13	Door 2	panelled painted white, lever handle brushed chrome		
14	Frame & architrave 2	painted white		
15	Threshold 3	wood		
16	Door 3	panelled painted white, lever handle brushed chrome	4 scuffs	wear & tear
17	Frame & architrave 3	painted white		
18	Threshold 4	wood		
19	Door 4	panelled painted white, lever handle brushed chrome		
20	Frame & architrave 4	painted white	slightly soiled	need light clean
21	Threshold 5	wood		
22	Door 5	panelled painted white, lever handle brushed chrome	dusty	need dusting
23	Frame & architrave 5	painted white		
Flooring				
24	Laminated	floorboards effect light, bead edge painted white	furniture pressure indents	wear & tear
Walls				
25	Skirting	painted white		
26	Wall	paper painted cream		
27	Hooks	4 picture hook(s) brass	missing Missing	needs replacing
28	Doorbell	round metal black		
29	Thermostat	Honeywell plastic white		
30	Security	entry phone system plastic cream Videx		
Windows				
31	Window	sash painted white, pull handles brass, fitted lock brass		

Room 2: Entrance Hall

	Description	Check-Out Update	Comment
Windows			
32	Window Sill	Painted white	
Ceiling			
33	Ceiling	Painted white, coving painted white	
34	Smoke Detector	Battery fitted	
Lighting			
35	Ceiling lighting	6 recessed spotlight(s) mount chrome	rose not fully secured noted
Heating			
36	Heating	double radiator painted white	
Sockets			
37	Electric light	2 double switch plastic white, 1 single switch plastic white	
38	Socket outlet	2 double switch plastic white	
Furnishings			
39	Table	console timber stained	4 ring mark(s) 3 chips to legs tenant liability wear & tear
40	Mirror	medium bevelled frame wood / gilt effect	
Stairs			
41	Banister Newel post	Painted white	
42	Banister spindles	Painted white	
43	Carpet	wall to wall fitted loop pile ecru	
44	Wall 2	paper painted cream	

Room 2: Storage		Description	Check-Out Update	Comment
Doors				
45	Threshold	wood		
46	Door	panelled painted white, lever handle brushed chrome		
47	Frame & architrave	painted white, cable		
Flooring				
48	Carpet	wall to wall fitted loop pile ecru	need light vacuum	noted
Walls				
49	Skirting	painted white		
50	Wall	paper painted cream		
51	Shelves	4 slatted wood		
52	Electric meter	prepayment with key, credit £4.10		
Ceiling				
53	Ceiling	painted white, coving painted white		
Lighting				
54	Ceiling lighting	pendant lamp holder		
Sockets				
55	Electric light	1 single switch plastic white		
Appliances				
56	Iron	Carlton Steam Spray grey/white		
57	Vacuum cleaner	cyclone upright 1600 watts with attachments Dyson yellow		
Furnishings				
58	Ironing board	metal with cover		

Room 3: Reception		Description	Check-Out Update	Comment
Doors				
59	Threshold	wood		
60	Door	panelled painted white, lever handle brushed chrome	3 chip(s)	wear & tear
61	Frame & architrave	painted white		
Flooring				
62	Laminated	floorboards effect light, bead edge painted white		
Walls				
63	Skirting	painted white		
64	Wall	paper painted cream		
65	Hooks	8 picture hook(s) brass		
66	Shelves	2 wood painted white, batten wood effect		
Windows				
67	Window	sash painted white, pull handles brass, fitted lock brass	interior seals mildew stained	need thorough clean
68	Window Sill	painted white	2 screw heads exposed	wear & tear
69	Curtain rail	wood with matching finials		
70	Curtains	lined length to floor pinch pleated cream, pelmet/tiebacks to match		
Ceiling				
71	Ceiling	painted white, coving painted white		
Lighting				
72	Ceiling lighting	10 recessed spotlight(s) mount chrome		
Heating				
73	Heating	double radiator painted white	dusty	need dusting
Sockets				
74	Electric light	2 single switch plastic white		
75	Socket outlet	8 double switch plastic white		
76	Telephone jack point	BT double plastic white		
77	Satellite and / or TV socket	double FM/TV, 2 cable with connector(s)		
Furnishings				
78	Table	console timber stained		
79	Table 2	coffee large wood		
80	Sofa	four seater chenille cream		
81	Chair (FFR filling)	to match sofa		
82	Picture	Hosef 24/56 framed gilt effect/timber stained effect	slightly soiled	need light clean
83	Telephone	push button with answer phone/LCD Display BT grey	soiled	need cleaning

Room 4: Reception 2 Description			Check-Out Update	Comment
---------------------------------	--	--	------------------	---------

Doors				
-------	--	--	--	--

84	Threshold	wood		
85	Door	panelled painted white, lever handle brushed chrome		
86	Frame & architrave	painted white		

Flooring				
----------	--	--	--	--

87	Laminated	floorboards effect light, bead edge painted white		
----	-----------	---	--	--

Walls				
-------	--	--	--	--

88	Skirting	painted white		
89	Wall	paper painted cream		
90	Hooks	4 picture hook(s) brass		

Windows				
---------	--	--	--	--

91	Window	sash painted white, pull handles brass, fitted lock brass		
92	Window Sill	painted white		
93	Curtain rail	wood with matching finials		
94	Curtains	lined length to floor pinch pleated cream, pelmet/tiebacks to match		

Ceiling				
---------	--	--	--	--

95	Ceiling	painted white, coving painted white		
----	---------	-------------------------------------	--	--

Lighting				
----------	--	--	--	--

96	Ceiling lighting	8 recessed spotlight(s) mount chrome		
----	------------------	--------------------------------------	--	--

Heating				
---------	--	--	--	--

97	Heating	double radiator painted white		
----	---------	-------------------------------	--	--

Sockets				
---------	--	--	--	--

98	Electric light	1 single switch plastic white	heavily soiled	need thorough clean
99	Socket outlet	4 double switch plastic white		
100	Telephone jack point	BT double plastic white		
101	Satellite and / or TV socket	single plastic white		

Appliances				
------------	--	--	--	--

102	Lamps	standard base chrome, shade frosted glass	bulb(s) not working	need replacing
-----	-------	---	---------------------	----------------

Furnishings				
-------------	--	--	--	--

103	Table	8 seater dining wood		
104	Table ware	6 place mats burgundy, 6 coasters burgundy		
105	Chair (FFR filling)	to match sofa		
106	Picture	Hosef 30/56 framed gilt effect/timber stained effect		

Room 5: Kitchen		Description	Check-Out Update	Comment
Doors				
107	Threshold	wood	general scratches	wear & tear
108	Door	panelled painted white, lever handle brushed chrome		
109	Frame & architrave	painted white		
110	Threshold 2	wood/brass		
111	Door 2	panelled painted white, lever handle brushed chrome, yale lock with cover chrome, 2 bolt(s) chrome		
112	Frame & architrave 2	painted white		
Flooring				
113	Tiled	ceramic riven autumnal, grout grey		
Walls				
114	Skirting	painted white	dusty	need dusting
115	Wall	paper painted cream	water stained mid - low level right of window	advise landlord
116	Wall (tiled)	tiled splash back to sink and units white		
117	Hooks	3 picture hook(s) brass		
118	Timer	digital plastic white Potterton		
119	Boiler	regular system with integrated timer Glow-Worm white	soiled	need cleaning
Windows				
120	Window	sash painted white, pull handles brass, fitted lock brass		
121	Window Sill	painted white		
122	Blinds	roman green with pull cord(s) toggles white		
123	Window 2	sash painted white, pull handles brass, fitted lock brass		
124	Window Sill 2	tiled green		
125	Blinds 2	roman green with pull cord(s) toggles white		
Ceiling				
126	Ceiling	painted white, coving painted white		
Lighting				
127	Ceiling lighting	6 recessed spotlight(s) mount chrome		
128	Wall lighting	2 uplighter(s) painted cream		
Heating				
129	Heating	double radiator painted white, cover lattice painted white		

Room 5: Kitchen		Description	Check-Out Update	Comment
Sockets				
130	Electric light	2 single switch plastic white		
131	Socket outlet	6 double switch plastic white, 4 fuse switch plastic white, cooker switch		
Appliances				
132	Cooker hood	wall mounted double mesh stainless steel Indesit chrome / black		
133	Cooker	double oven Bosch chrome / black, 3 shelve(s), grill pan with mesh and handle	shelves soiled	need cleaning
134	Hob	gas six ring Baumatic stainless steel combined oven		
135	Microwave	1000 watts Baumatic chrome / black		
136	Dishwasher	integrated Baumatic pastel		
137	Kettle	jug with base with lead Hinari chrome / black		
138	Toaster	4 slicer Dualit chrome / black	dusty/burnt	need cleaning
139	Sandwich toaster	Breville white		
140	Refrigerator Freezer	integrated Candy tall white, 2 salad box(s), 4 shelve(s) glass, 6 door shelve(s) 2 with lid(s), 3 drawers plastic coated, 2 ice cube holder(s)		
141	Washer dryer	integrated front loading Hotpoint white		
Furnishings				
142	Glassware	6 wine, 6 juice, 6 tumblers, 1 measuring jug		
143	Crockery	set white, 6 dinner plates, 6 side plates, 6 tea plates, 6 cereal bowls, 6 mugs		
144	Kitchen miscellaneous	1 broom, 1 mop, 1 chopping board		
145	Manuals	dish washer, vacuum, washer dryer		
146	Keys	1 radiator bleed, 2 kitchen door yale		
Units				
147	Kitchen units	range of fitted floor mounted/wall mounted laminated effect dark, cornices/plinths to match, interiors laminated white, knob handles brushed chrome, 9 shelves, 6 drawer (s)		
148	Worktops	granite green		
149	Sink	Belfast bowl white, dual lift tap brushed chrome, silver plug(s) & chain		

Room 6: Garden

Rear

	Description	Check-Out Update	Comment
Flooring			
150	Patio	slabs concrete	
151	Lawn	turf, brick border	
Walls			
152	Wall	brick painted white	
153	Fence	wood timber stained slatted with trellis	
154	Gate	timber stained, yale lock 2 bolt(s) black	
Lighting			
155	Garden lighting	6 soil spike(s), 2 wall mounted lanterns black	
Appliances			
156	Lawn mower	Flymo Challenge with grassbox orange	
157	Strimmer	Black & Decker	
Furnishings			
158	Bushes	planted	
159	Beds	planted	severely weeded/over grown tenant liability
160	Bench	slatted timber stained painted grey	
161	Recycle bin	2 with lids	
162	Wheelie bin	with lid	
163	Washing line	rotary with cover	Missing needs replacing

Room 7: WC		Description	Check-Out Update	Comment
Doors				
164	Threshold	wood		
165	Door	panelled painted white, lever handle brushed chrome		
166	Frame & architrave	painted white		
Flooring				
167	Tiled	ceramic stressed effect green		
Walls				
168	Skirting	painted white		
169	Wall	paper painted cream		
170	Wall (tiled)	tiled splash back to basin white		
171	Toilet roll holder	chrome		
172	Ventilation	vent painted to match		
Windows				
173	Window	sash painted white, pull handles brass, fitted lock brass		
174	Window Sill	painted white		
175	Blinds	roman green with pull cord(s) toggles white		
Ceiling				
176	Ceiling	painted white, coving painted white		
Lighting				
177	Ceiling lighting	1 recessed spotlight(s) mount chrome		
Heating				
178	Heating	radiator painted white single with thermostatic control		
Suites				
179	Basin	wall mounted white, Ideal Standard monobloc dual tap brushed chrome, flip waste chrome	taps surround heavily scaled	need thorough clean
180	WC	white pan with seat and flap to match Ideal Standard		
181	Cistern	to match with push button dual flush chrome		

Room 8: Landing		Description	Check-Out Update	Comment
Doors				
182	Threshold	wood		
183	Door	panelled painted white, lever handle brushed chrome		
184	Frame & architrave	painted white	3 chips, 2 gouge(s)	wear & tear
185	Threshold 2	wood		
186	Door 2	panelled painted white, lever handle brushed chrome		
187	Frame & architrave 2	painted white		
188	Threshold 3	wood		
189	Door 3	panelled painted white, lever handle brushed chrome	handle oxidised	wear & tear
190	Frame & architrave 3	painted white		
Flooring				
191	Carpet	wall to wall fitted loop pile ecru		
Walls				
192	Skirting	painted white		
193	Wall	paper painted cream		
194	Mirror	medium bevelled frame wood / gilt effect	4 chip(s) to frame	wear & tear
Windows				
195	Window	sash painted white, pull handles brass, fitted lock brass		
196	Window Sill	painted white		
Ceiling				
197	Ceiling	painted white, coving painted white		
198	Ceiling attachment	loft hatch & frame painted white		
199	Smoke Detector	battery fitted		
Lighting				
200	Ceiling lighting	candelabra four bulb chain support antique effect brass		
Heating				
201	Heating	double radiator painted white, cover lattice painted white		
Sockets				
202	Electric light	2 single switch plastic white		
203	Socket outlet	1 double switch plastic white		

Room 8: Storage		Description	Check-Out Update	Comment
Doors				
204	Threshold	none		
205	Door	painted white, lever handle brass		
206	Frame & architrave	painted white		
207	Topboxes	to match		
Flooring				
208	Carpet	wall to wall fitted loop pile ecru		
Walls				
209	Skirting	painted white		
210	Wall	paper painted cream		
211	Timer	Landis & Gyr plastic white		
212	Stop cock	fitted		
213	Gas meter	digital		
214	Water Tank	factory insulated lagged with pressure gage, water pump, pipe work copper		
215	Shelves	2 slatted wood		
Ceiling				
216	Ceiling	painted white, coving painted white		
Sockets				
217	Socket outlet	3 fuse switch plastic white		
Furnishings				
218	Shower curtain	plastic with curtain rings white		
219	Linen	4 pillow case(s) cream, 2 double fitted sheet cream		

Room 9: Bedroom		Description	Check-Out Update	Comment
Doors				
220	Threshold	wood		
221	Door	panelled painted white, lever handle brushed chrome, 1 double hook(s) brass		
222	Frame & architrave	painted white		
Flooring				
223	Carpet	wall to wall fitted loop pile ecru		
Walls				
224	Skirting	painted white	worn to corner edge	wear & tear
225	Wall	paper painted cream		
226	Hooks	3 picture hook(s) brass		
227	Hooks 2	2 screw(s)		additional
Windows				
228	Window	sash painted white, pull handles brass, fitted lock brass		
229	Window Sill	painted white		
230	Curtain rail	wood with matching finials		
231	Curtains	lined length to sill pinch pleated cream, decorative pelmet/tiebacks to match		
Ceiling				
232	Ceiling	painted white, coving painted white		
Lighting				
233	Ceiling lighting	treble bulb chandelier chain support brass		
Heating				
234	Heating	double radiator painted white		
Sockets				
235	Electric light	1 single switch plastic white		
236	Socket outlet	4 double switch plastic white	1 soiled	need cleaning
237	Telephone jack point	single plastic white		
Appliances				
238	Lamps	table base decorative wood, shade card speckled cream		
Furnishings				
239	Bed	double slatted base pine, foot and headboard pine		
240	Mattress	double checked blues		
241	Table	bedside lacquered wood effect		
242	Table 2	bedside lacquered wood effect		

Room 9: Bedroom	Description	Check-Out Update	Comment
-----------------	-------------	------------------	---------

Furnishings

243	Chest of drawers	8 drawer pine, knob handle (s) to match	
244	Bin	small wicker	

Room 10: Bathroom		Description	Check-Out Update	Comment
Doors				
245	Threshold	wood	general scratches	wear & tear
246	Door	panelled painted white, lever handle brushed chrome		
247	Frame & architrave	painted white	2 chips	wear & tear
Flooring				
248	Carpet	wall to wall fitted loop pile ecru	1 iron burn	tenant liability
Walls				
249	Skirting	painted white		
250	Wall	paper painted cream		
251	Wall (tiled)	tiled splash back to bath/basin white, with decorative border tiled mosaic stone		
252	Mirror	large bevelled with caps chrome		
253	Toilet roll holder	chrome		
254	Soap dish	chrome to match		
255	Cabinet	laminated white door(s) mirrored, knob handle(s) chrome, 2 shelve(s) glass, sectioned		
Ceiling				
256	Ceiling	painted white, coving painted white		
257	Extractor fan	white Execlair		
Lighting				
258	Ceiling lighting	4 recessed spotlight(s) mount chrome	bulb(s) not working	need replacing
Heating				
259	Heating	radiator heated towel rail chrome		
Sockets				
260	Electric light	pull cord toggle wood		
261	Socket outlet	isolator shaver plastic white		
Suites				
262	Basin	pedestal white Ideal Standard, monobloc dual tap brushed chrome, flip waste chrome		
263	Bath	Ideal Standard fitted white, monobloc tap chrome with flexible hose to showerhead white	drainage/taps surround slightly soiled/scaled	need cleaning
264	Bath side panel	tiled to match	5"crack	tenant liability
265	WC	white pan with seat and flap to match Ideal Standard		

Room 10: Bathroom	Description	Check-Out Update	Comment
-------------------	-------------	------------------	---------

Suites

266	Cistern	to match with push button dual flush Ideal Standard	
267	Shower screen	D end etched glass framed stainless steel	

Furnishings

268	Bath mat	set of 2 looped towelling cream	
269	Toilet brush	plastic white with holder to match	

Room 11: Bedroom

2	Description	Check-Out Update	Comment
Doors			
270	Threshold	wood	
271	Door	panelled painted white, lever handle brushed chrome, 1 double hook(s) brass	
272	Frame & architrave	painted white	
Flooring			
273	Carpet	wall to wall fitted loop pile ecru	8 small spot marks, soiled to walkways need cleaning
Walls			
274	Skirting	painted white	
275	Wall	paper painted cream	
276	Hooks	2 picture hook(s) brass	
Windows			
277	Window	sash painted white, pull handles brass, fitted lock brass	exterior glazing slightly soiled need light clean
278	Window Sill	painted white	
279	Curtain rail	wood with matching finials	
280	Curtains	lined length to sill pinch pleated cream, decorative pelmet/tiebacks to match	
Ceiling			
281	Ceiling	painted white, coving painted white	
Lighting			
282	Ceiling lighting	treble bulb chandelier chain support brass	
Heating			
283	Heating	double radiator painted white	
Sockets			
284	Electric light	1 single switch plastic white	
285	Socket outlet	4 double switch plastic white	
Appliances			
286	Lamps	table base decorative wood, shade card speckled cream	
Furnishings			
287	Bed	single slatted base pine, foot and headboard pine	
288	Mattress	single checked blues	2 spot mark(s) need spot cleaning
289	Table	bedside lacquered wood effect	
290	Chest of drawers	8 drawer pine, knob handle (s) to match	dusty need dusting
291	Linen	single mattress protector white	

Room 12: Bathroom

2	Description	Check-Out Update	Comment
Doors			
292	Threshold	wood	
293	Door	panelled painted white, lever handle brushed chrome	flaking to joinery wear & tear
294	Frame & architrave	painted white	
Flooring			
295	Carpet	wall to wall fitted loop pile ecru	2 small residual stains landlords discretion
Walls			
296	Skirting	painted white	
297	Wall	paper painted cream	
298	Wall (tiled)	tiled splash back to bath/basin white, with decorative border tiled mosaic stone	
299	Mirror	large bevelled with caps chrome	
300	Toilet roll holder	chrome	slightly loose wear & tear
301	Soap dish	chrome to match	slightly soiled loose need cleaning wear & tear
302	Cabinet	laminated white door(s) mirrored, knob handle(s) chrome, 2 shelve(s) glass, sectioned	
Windows			
303	Window	sash painted white, opaque, pull handles brass, fitted lock brass	
304	Window Sill	tiled to match	
305	Blinds	venetian white with pull cord (s) toggles light wood	
Ceiling			
306	Ceiling	painted white, coving painted white	
307	Extractor fan	white Execlair	soiled need cleaning
Lighting			
308	Ceiling lighting	4 recessed spotlight(s) mount chrome	
Heating			
309	Heating	radiator heated towel rail chrome	
Sockets			
310	Electric light	pull cord toggle wood	
Suites			
311	Basin	pedestal white Ideal Standard, monobloc dual tap brushed chrome, flip waste chrome	

Room 12: Bathroom

2	Description	Check-Out Update	Comment
Suites			
312	Bath	Ideal Standard fitted white, monobloc tap chrome with flexible hose to showerhead white	
313	Bath side panel	tiled to match	
314	WC	white pan with seat and flap to match Ideal Standard	
315	Cistern	to match with push button dual flush Ideal Standard	soiled hair line crack need cleaning tenant liability
316	Bidet	to match, taps to match Ideal Standard	
317	Shower screen	D end etched glass framed stainless steel	
Furnishings			
318	Bath mat	set of 2 looped towelling cream	soiled need cleaning
319	Toilet brush	plastic white with holder to match	
320	Linen	4 bath towel(s) cream, 4 hand towel(s) cream, 2 face cloth(s) cream	Missing needs replacing

Exterior



Exterior Block

Room 5: Kitchen



sink

Room 7: WC



basin

Room 9: Bedroom



window

Room 12: Bathroom 2



tiles